

Best Practice

Plastic Recycling on a ship

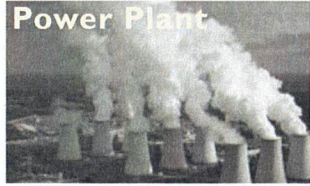

- + Reduced investment risk: mobility and flag state
- + Shipyards are leaders in building complex systems
- + Turnkey delivery – including testing and commissioning
- + No additional space required at the side of use

Input + Output

Processing of Plastic Waste: 60,000 t/a
Sorting, Baling, Waste to Energy, Science Laboratory

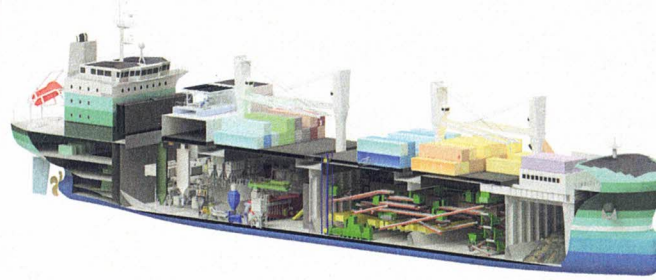

Input

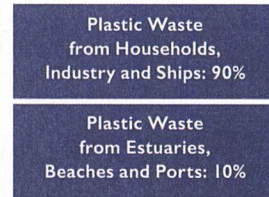

Output

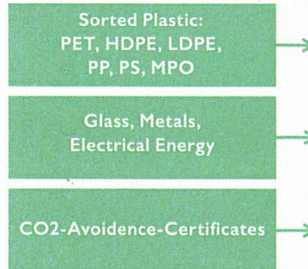

Innovative Details

Transfer Terminal, Tipping Device, Bale Lift, BAT-Flue Gas Cleaning, Science-Laboratory, Waste Collection-Catamarans

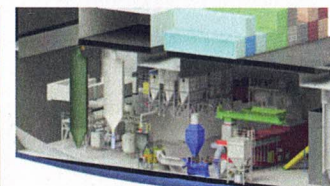

OEOO Contact

Wischhofstr. 1-3, D-24148 Kiel
Center for Marine Technology and Sea Fish Market

OEOO e.V.

harald.frank@oneearth-oneocean.de
+49 176 30326723
www.oeeo.world



Board / CEO

Günther Bonin

ended his involvement as an IT entrepreneur in 2011 to counteract water pollution. With the establishment of the non-profit NGO One Earth-One Ocean e.V., he shows effective environmental protection in many internationally recognized projects.



Senior Naval Architect

Prof. Andreas Meyer-Bohe (Dipl.-Ing.)

was a project manager at the Sietas shipyard, head of the Tech. Offices of the Lindenu shipyard and director of the institute for shipbuilding at the University of Applied Sciences in Kiel. His professional skills lie in the areas of ship design, hydrostatics, maritime environmental protection and project management.



Senior Manager Finance & Business

Dr. Harald Frank (Dipl. Volksw.)

was CFO in internationally oriented medium-sized companies for 15 years. As a consultant and interim manager, he has specialized in the development, financing and management of sustainability projects for many years.



Senior Plant Engineer

Peter Berlekamp (Dipl.-Ing.)

has held various management positions in the Sulo Group as well as at Tönsmeier and in the Prezero Group for the operational management and planning of sorting and processing plants responsible.